





## ECO-RESPONSIBLE DEVELOPER

The GreenRE logo has been the hallmark symbol for buildings and townships nationwide that encourages sustainable living for residents and developer.

At EXSIM, every venture we take utilised technology in an intelligent and organic manner for the advancement of mankind.

We are also equally intensifying our efforts to create buildings with a specific character which exemplify innovative green features.

## BEAUTY FROM THE EARTH

Philosopher and poet George Santayana said, "The earth has its music for those who will listen." The breathtaking, dazzling wonders of this planet have never ceased to amaze and inspire the human mind. From majestic structures to the humblest wildflowers dancing in vast fields, people have always connected with nature and drawn ideas from her beauty. D'Terra Residences comes from this same spirit of revelation - a tribute to nature, a concept birthed from the brilliance and magic of this earth we call home.



Artist's Impression

---

## INSPIRED BY THE LAND

---

Awash with warm earthy tones, D'Terra Residences honours the land on which it stands on with bold imagination and inventiveness. A single, sturdy monolith rises into the sky, quietly elegant in its contemporary design. Against this, a series of colours, layers and textures are projected to create a striking masterpiece mimicking nature with adroit cleverness. Steps, terraces and interval levels model the natural terrain. Undulating lines and curved formations elevate the space with earth's own artistry. Choice plants and landscaping recreate the stunning lushness of the wild, while wood and stone hardscapes complete the imagery.



Podium  
Street View

Artist's Impression



Podium  
Grand Arrival Lounge

Artist's Impression



Podium  
Garden Pool

Artist's Impression



Podium  
Labyrinth Hammock Garden

Artist's Impression

# FLOOR PLAN

## FLEXIBLE LIVING FOR ALL

Individual preferences are catered to with a choice of 3 bedrooms and 3+1 bedrooms units. Ranging in size from 956 to 1,179 sq ft with flexible, hackable walls, the residences are designed to optimize space usage while allowing room for adaptation and personal creativity. For elderly or special needs residents, D'Terra Residences also offers selected units with build-in ramps at the foyer and bathroom in addition to hackable walls to accommodate different living needs.

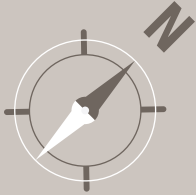

NORTHWEST  
SUNGAI BULOH

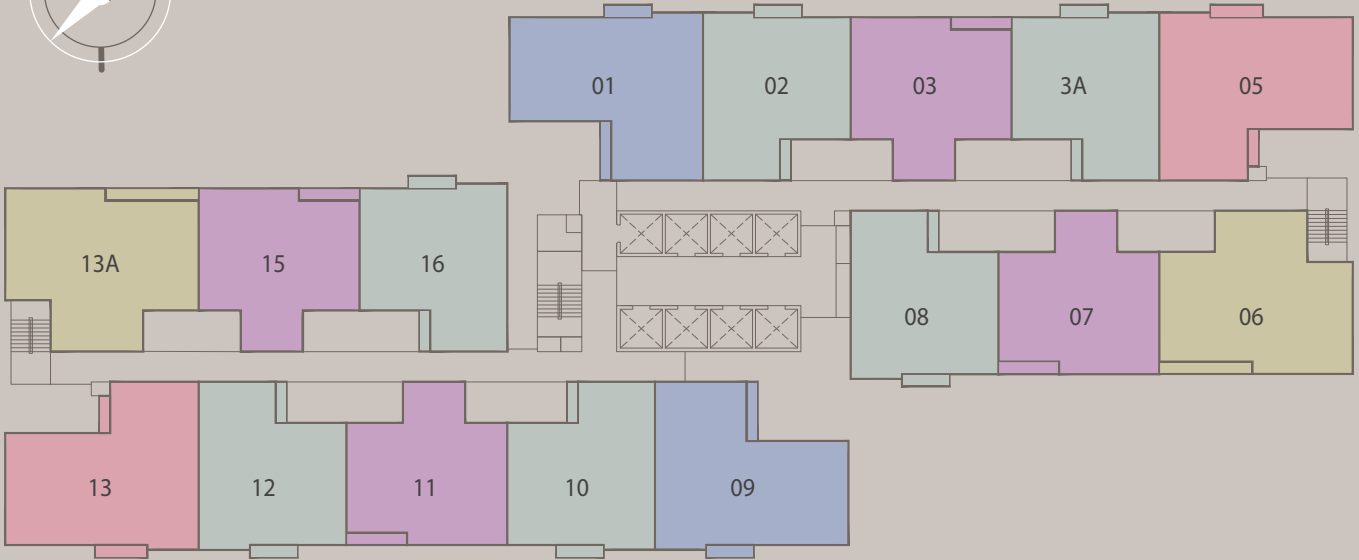

SOUTHEAST  
TTDI / MON'T KIARA

- TYPE A1 / A2
- TYPE A3 / A4
- TYPE B1 / B2
- TYPE B3 / B4
- TYPE B5 / B6

# LAYOUT PLANS

## TYPE A1

3R2B (With Balcony)  
956sq.ft.

1. Foyer
2. Yard
3. Kitchen
4. Dining
5. Living
6. Balcony
7. Bedroom 1
8. Bedroom 2
9. Bathroom
10. Utility
11. Master Bedroom
12. Master Bathroom
13. A/C Ledge

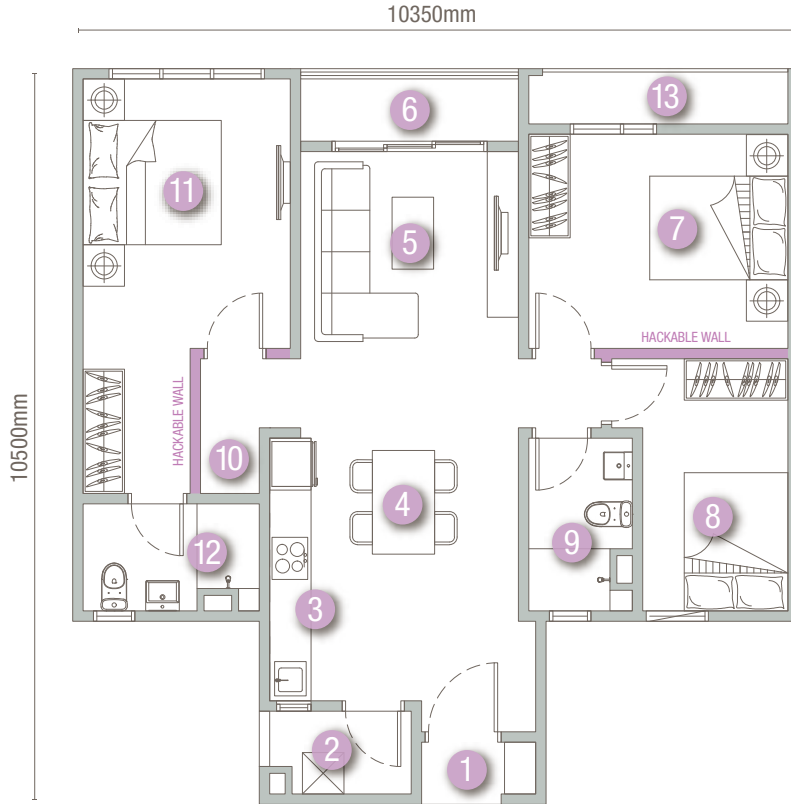

## TYPE A2

3R2B (Without Balcony)  
956sq.ft.

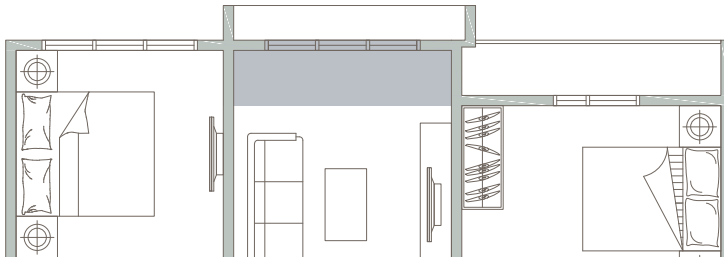

# TYPE A3

3R2B (With Balcony)

956sq.ft.

1. Foyer
2. Kitchen
3. Yard
4. Dining
5. Living
6. Balcony
7. Utility
8. Bathroom
9. Bedroom 1
10. Bedroom 2
11. Master Bedroom
12. Master Bathroom
13. A/C Ledge

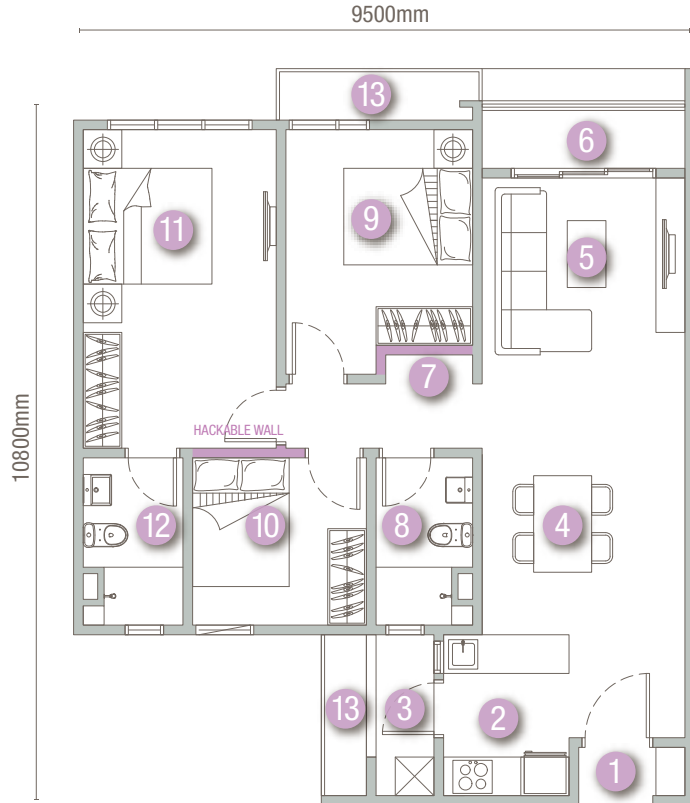

# TYPE A4

3R2B (Without Balcony)

956sq.ft.

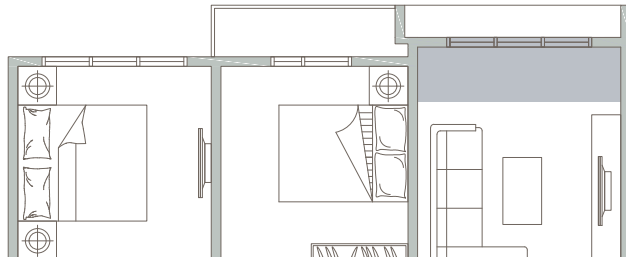

# TYPE B1

3R2B (With Balcony)

1,151sq.ft.

1. Foyer
2. Kitchen
3. Yard
4. Dining
5. Living
6. Balcony
7. Bedroom 2
8. Bedroom 1
9. Utility
10. Study
11. Bathroom
12. Master Bedroom
13. Master Bathroom
14. A/C Ledge

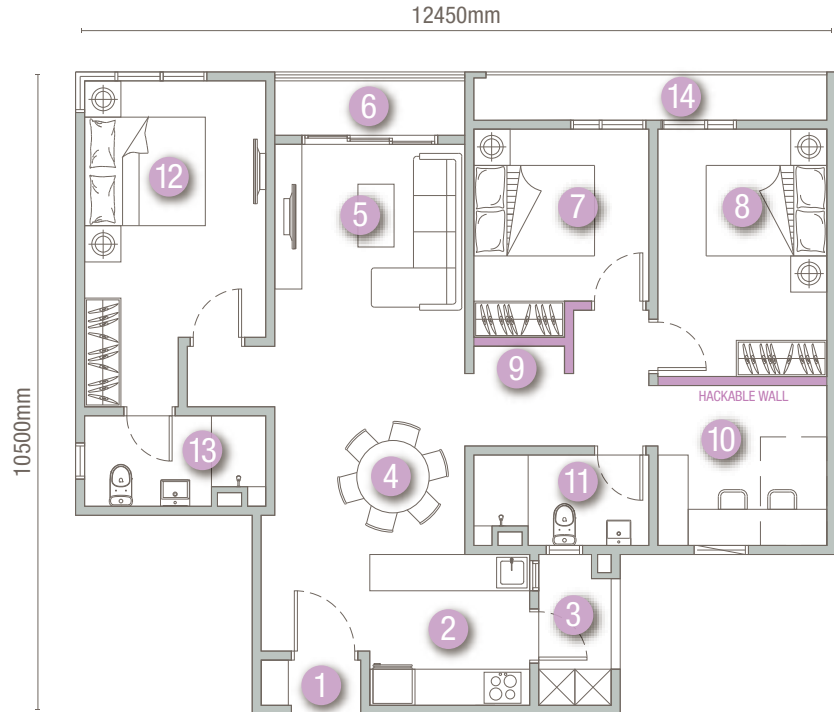

# TYPE B2

3R2B (Without Balcony)

1,151sq.ft.

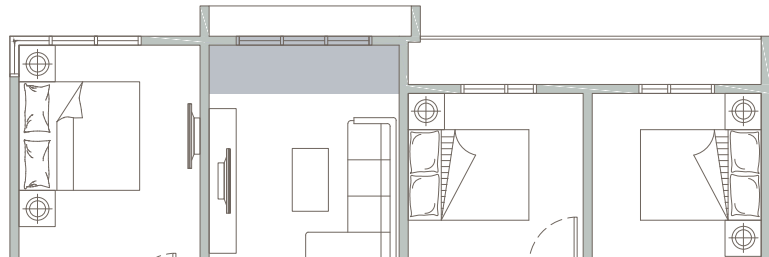

# TYPE B3

3R2B (With Balcony)

1,151sq.ft.

1. Foyer
2. Kitchen
3. Yard
4. Dining
5. Living
6. Balcony
7. Bedroom 2
8. Bedroom 1
9. Utility
10. Study
11. Bathroom
12. Master Bedroom
13. Master Bathroom
14. A/C Ledge

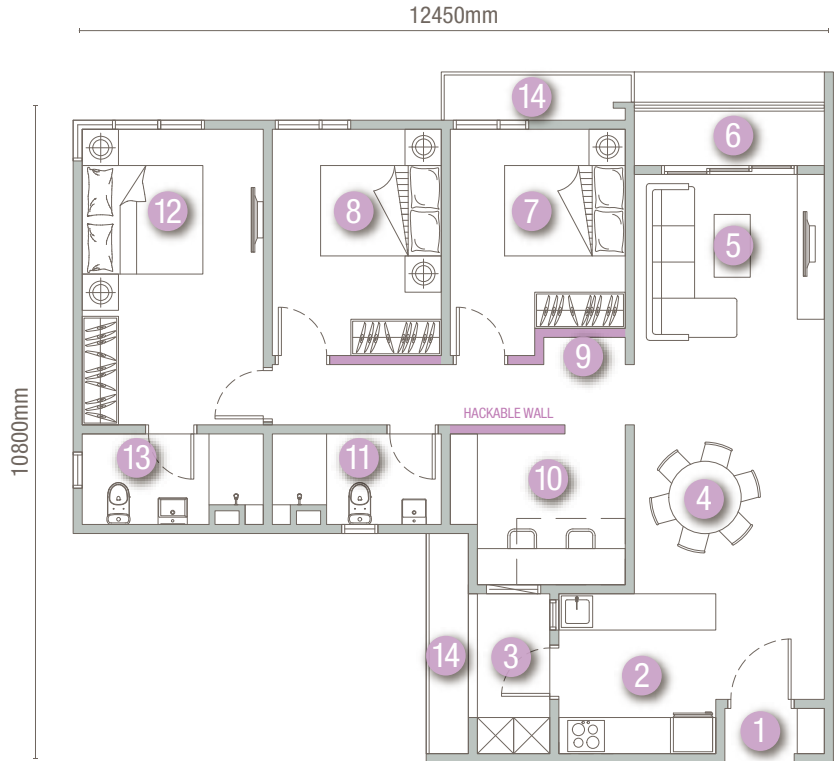

# TYPE B4

3R2B (Without Balcony)

1,151sq.ft.

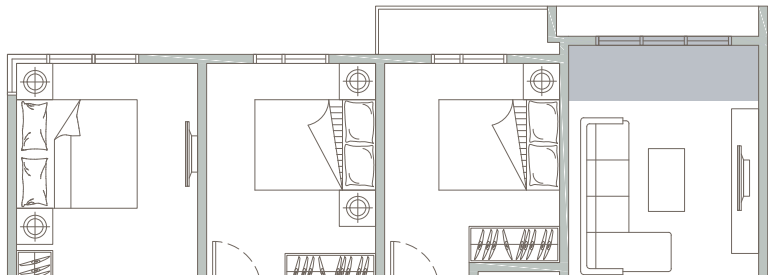

# TYPE B5

3R2B (Elderly-Friendly | With Balcony)  
1,179sq.ft.

1. Foyer
2. Kitchen
3. Yard
4. Dining
5. Living
6. Balcony
7. Bedroom 2
8. Bedroom 1
9. Utility
10. Study
11. Bathroom
12. Master Bedroom
13. Master Bathroom
14. A/C Ledge

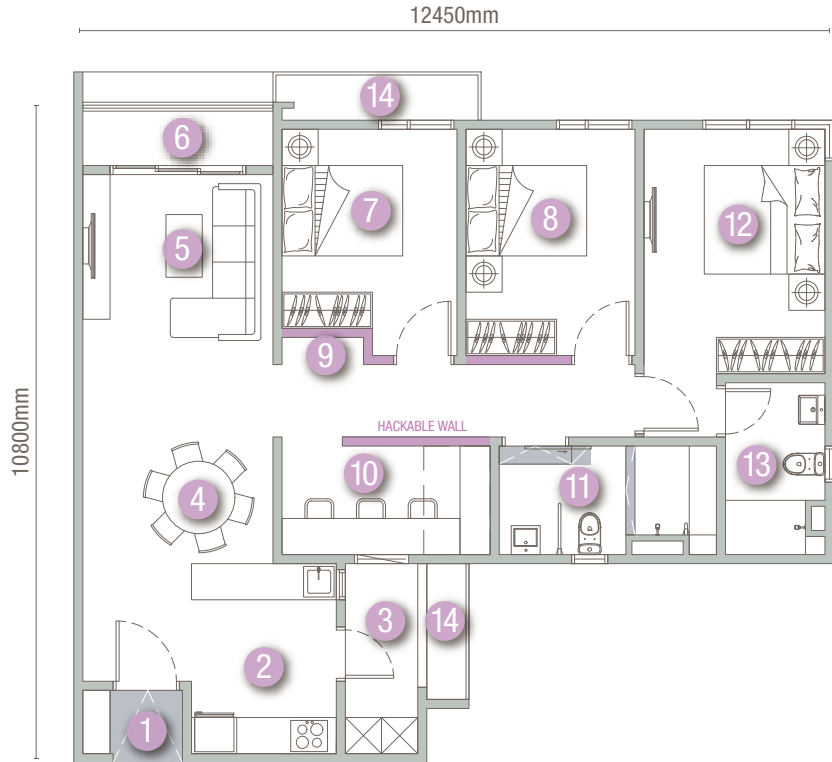

# TYPE B6

3R2B (Elderly-Friendly | Without Balcony)  
1,179sq.ft.

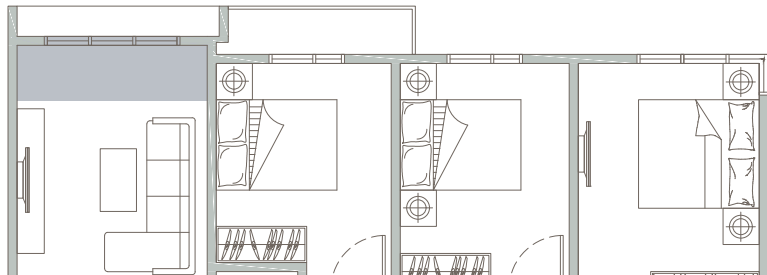

---

# THE BETTER WAY OF LIFE

---

Quality of life begins with a home that caters to the whole person - body, mind and soul. At D'Terra Residences, this is well catered for in a range of facilities - pavilions and lounges for rest and rejuvenation; sporting amenities such as Garden Pool and FITastic Gym; designated spaces for children like Kid's Learning Room; communal gathering areas like Sizzling Bar and Moonlight Deck. Beyond the walls of the residences, bustling commercial, retail and F&B areas within the townships await while a sprawling gateway to nature, welcomes.



Podium  
Entertainment Room



Artist's Impression





## PODIUM

01. WATER GARDEN
02. GARDEN POOL
03. WATERSIDE CABANA
04. JACUZZI
05. FITASTIC GYM
06. ENTERTAINMENT ROOM
07. CABANA LOUNGE
08. FUN POOL
09. KID'S LEARNING ROOM
10. LABYRINTH HAMMOCK GARDEN
11. COWORKING LOUNGE
12. GRAND ARRIVAL LOUNGE
13. CHILL MUSIC LOUNGE
14. BIOLOGICAL POND
15. MULTI-USE GALLERY
16. HALF BASKETBALL COURT
17. KID'S PLAYGROUND

## SKY DECK

18. SIZZLING BAR
19. EDIBLE GARDEN
20. MOONLIGHT DECK
21. FITASTIC GARDEN
22. REFELXOLOGY STROLL
23. YOGA DECK

# FACILITIES PLAN



Podium  
Chill Music Lounge

Artist's Impression



Podium  
FITastic Gym

Artist's Impression



Podium  
Kid's Learning Room

Artist's Impression



Podium  
Kid's Playground

Artist's Impression

---

## A PRIME ADDRESS IN PETALING JAYA

---

D'Terra Residences forms part of an up-and-coming integrated township in North Petaling Jaya. It is surrounded by every kind of conveniences within the township, including a sprawling new green lung that envelops one facade of the building. A network of roads, highways and expressways also connects the area to other major cities and neighbourhoods where ample facilities and amenities are available.



Podium  
**Coworking Lounge**

Artist's Impression



Sky Deck  
**Yoga Deck**

Artist's Impression



Sky Deck  
**FITastic Garden**

Artist's Impression

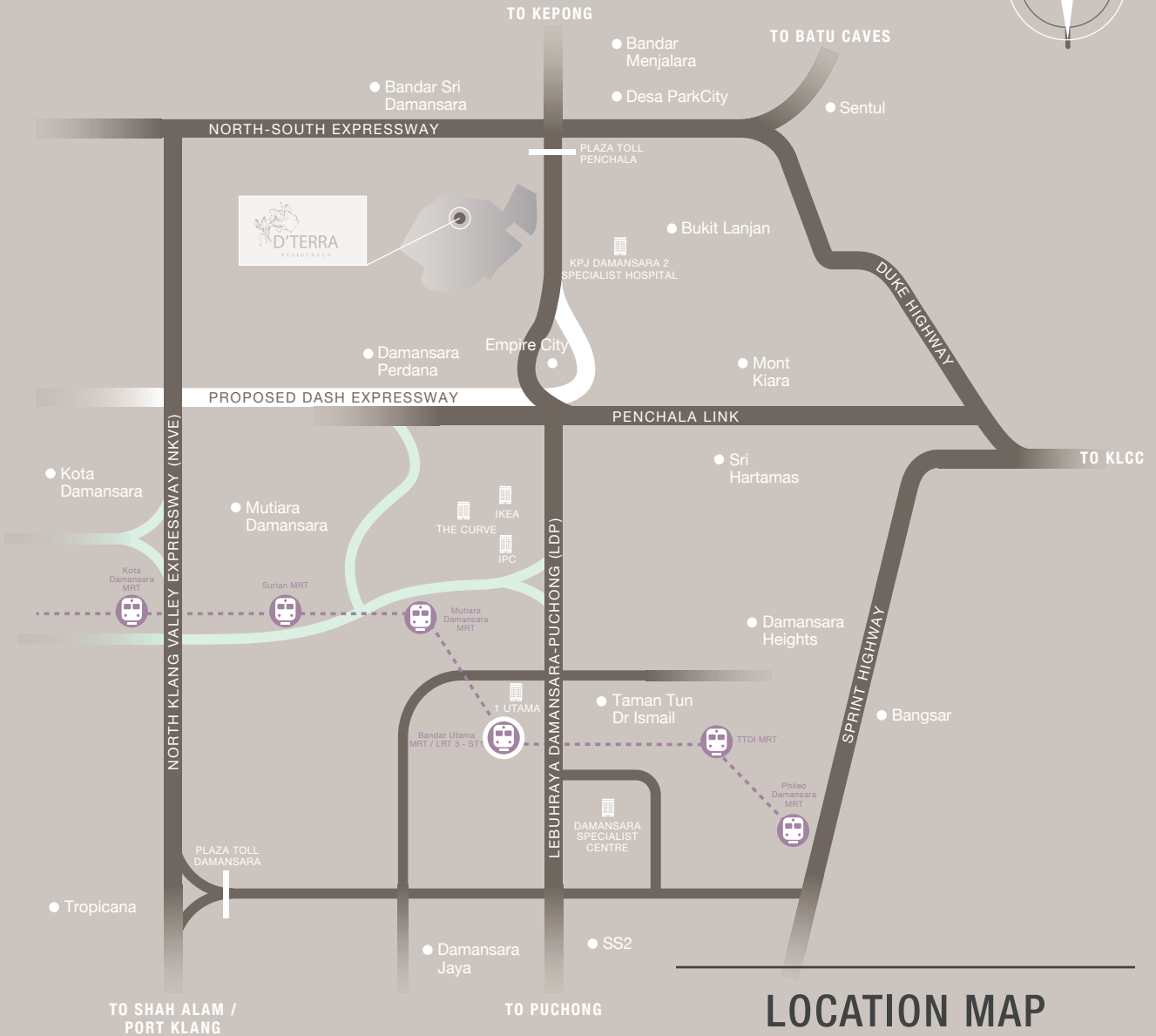
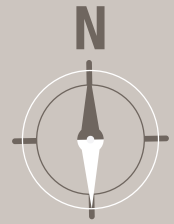



## NEW AGE INGENUITY



**MIGHTYPROP SDN BHD** (Registration No.: 201801037852 (1299882-V))  
(A member of EXSIM Group)

No. 18, Block 2, Jalil Link, Jalan Jalil Jaya 2,  
Bukit Jalil, 57000 Kuala Lumpur.

T +603 8993 9911

F +603 8993 9922

E [info@exsim.com.my](mailto:info@exsim.com.my)

W [exsim.com.my](http://exsim.com.my)



**EXSIM | D'TERRA RESIDENCES SALES GALLERY**

G79, Ground Level, Empire City, No 8, Jalan Damansara, PJU 8,  
47820 Petaling Jaya,  
Selangor Darul Ehsan.

T +603 7620 5002 W [dterra.com.my](http://dterra.com.my)

• Pemaju: MIGHTYPROP SDN BHD [201801037852 (1299882-V)] • No Lesen Pemaju: 20011/11-2027/1104(A) • Tempoh Sah: 10/11/2022 – 09/11/2027 • No. Permit Iklan & Jualan: 20011-2/01-2026/0074(A)-(S) • Tempoh Sah: 20/01/2023-19/01/2026 • Pihak berkuasa yang meluluskan: MAJLIS BANDARAYA PETALING JAYA • No Pelan Rujukan.: MBPJ/120100/T/P10/721/2022(0) • Pegangan Tanah: Pajakkan Sehingga 80 Tahun, berakhir 18 OGOS 2102 • Sekatan Kepentingan: Tanah ini tidak boleh dipindahmilik, dipajak atau digadai melainkan setelah mendapat kebenaran Pihak Berkuasa Negeri • Beban Tanah: GADAIAN ( RHD BANK BERHAD) • Tarikh Jangka Siap: OKT 2027 • Bilangan Unit: 767 Units • Harga Jualan: RM749,870.00(Min) – RM979,330.00(Mak) • Bil Unit Tempat Letak Kereta: 1 Unit • Jenis Pembangunan: PANGSAPURI SERVIS

All information, items and/or products herein contained and/or displayed, including but not limited to measurement, features, materials, specifications, brands, colours, plans, drawings, images, pictures, visuals renditions, illustrations and presentation of interiors, furniture and fittings layout, landscapes, roads, access, lifestyle, scale models, show units and/or development are artist's impressions/renderings for illustration purposes only and are subject to change as may be required and/or recommended by the relevant authorities and/or the developer's architects, engineers and/or consultants without prior notification to you. Nothing contained herein shall be taken as identical representation of the actual state thereof or constitute or be construed to constitute an offer, a contract, part of the sale and purchase agreement (SPA), a representation and/or warranty on the part of the developer, unless expressly and specifically incorporated in the SPA. Prospective purchasers are advised to read and scrutinize the SPA together with its enclosures or to engage relevant independent professionals for advice prior to signing of the SPA. The developer and/or other related companies and parties shall neither be held responsible for any claims, error or inaccuracy nor be liable for any losses, damages, costs, expenses, or liabilities that may be incurred, suffered or sustained resulting from any reliance on any information, items and/or products herein contained and/or displayed or any part thereof.